

PIN FUNCTION:

NO.	SYMBOL	NO.	SYMBOL
1	NC	20	VCC
2	PS0	21	C5P
3	PS1	22	C3P
4	/CS	23	C1N
5	/RES	24	C1P
6	RS	25	C2P
7	R/W	26	C2N
8	E/RD	27	C4P
9	D0	28	REF
10	D1	29	VEXT
11	D2	30	INTRS
12	D3	31	VL2
13	D4	32	VL3
14	D5	33	VL4
15	D6	34	VL5
16	D7	35	VL6
17	VDD	36	VR
18	VCI	37	OSC1
19	VSS	38	NC

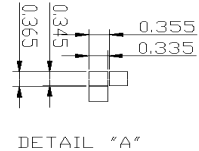

NOTE:
 1.DISPLAY TYPE:FSTN
 2.VIEWING DIRECTION:6 O'CLOCK
 3.POLARIZER:REFLECTIVE/POSTIVE △
 4.OPERATING VOLTAGE:14V
 5.OPERATING TEMP:0°~+50°
 6.STDRAGE TEMP:-10°~+60°
 7.DIRVE METHOD:DUTY1/128 BIAS1/12
 8.IC:SSD1852T2R1
 9.VDD:3.3V

FEATURE

- 1. FSTN, Positive, Reflective**
- 2. IC: SSD1852BT2R1**
- 3. 1/128Duty, 1/12Bias, 6 O'clock**
- 4. Backlight: NA, Display: Back, Background: White**

Pin NO	Symbol	Pin NO	Symbol
1	NC	28	REF
2	PS0	29	VEXT
3	PS1	30	INTRS
4	/CS	31~35	VL2~VL6
5	/RES	36	VR
6	RS	37	OSC1
7	R/W	38	NC
8	E/RD		
9~16	D0~D7		
17	VDD		
18	VCI		
19	VSS		
20	VCC		
21	C5P		
22	C3P		
23	C1N		
24	C1P		
25	C2P		
26	C2N		
27	C4P		

MECHANICAL DATA		
Item	Standard Value	Unit
Module Dimension	55.5(W) x 74.8(H) x 2.15(T)	mm
Viewing Area	48(W) x 49.2(H)	mm
Dot Size	0.335(W) x 0.345(H)	mm
Dot Pitch	0.355(W) x 0.365(H)	mm

ABSOLUTE MAXIMUM RATING					
Item	Symbol	Standard Value			Unit
		min	typ	max	
Supply Voltage	VDD	-0.3	—	+4.0	V
	VCC	-0.3	—	15	
Input Volyage	VIN	-0.3	—	VDD+0.3	V

ELECTRONICAL CHARACTERISTICS						
Item	Symbol	Condition	Standard Value			Unit
			min	typ	max	
Input Voltage	V _{IH}	VDD=3.3V±5%	0.8VDD		VDD	V
	V _{IL}		0		0.2VDD	
Current Consumption	IDD	VDD=3.3V Vop=14V	—	2.12	3	mA
Supply Voltage For Logic	VDD-VSS	—	2.8	3.3	3.8	V
LCD Drive Voltage	Vop=VL6 -VSS	Ta=25°C	—	14	—	V